

Remodeled Kitchens & Baths

Dramatic Makeovers



Tina Skinner & Melissa Cardona



A Schiffer Design Book

Penthouse Appointments

Commissioned by a client confined to a high-rise apartment, these designers had a long list of wishes to fulfill. A confining, dead-end kitchen was to be opened to the rest of the entertaining areas in the home, made larger to increase storage and counter space, include an eating area and bar, and to incorporate all of the modern conveniences while concealing them behind a nostalgic, furniture-like façade.





A hand-painted wall mural depicts a fabulous scene from the client's favorite Italian village, inviting visitors to the back of the kitchen, where island seating affords them a piece of the action, the host the pleasure of their company.

BEFORE



Because he likes to entertain, this high-rise apartment owner placed priority on a bar in his gathering area. A working fireplace was also created to form a focal point for the room, and the view beyond was framed, a table placed there to invite passage toward the light.



BEFORE

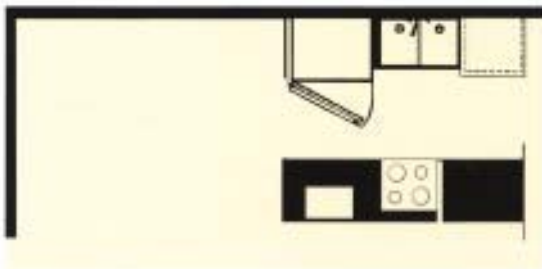

AFTER

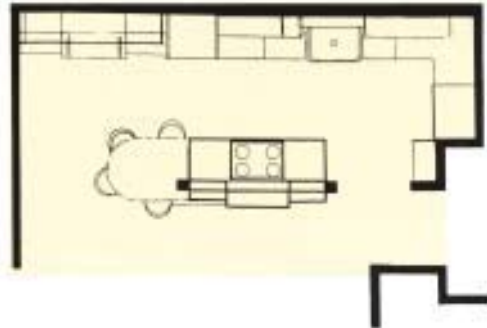

⦿ The overall space and counters were increased by closing the original entryway, taking space from the hall, and eliminating the walls between the kitchen and former dining room.

⦿ An apron sink, vintage faucet, custom tin panels, rollout baskets, and hardware were chosen to create a nostalgic look.

⦿ Modern appliances including a Subzero 700 Series refrigeration system, a fully integrated dishwasher, warming drawer, cooking range, and even the ventilation system all but disappear behind wooden facades.